

Schedule
A

NEW ADDITION EXISTING BUILDING

LINTEL SCHEDULE			
NO.	TYPE	SIZE	REMARKS
1	↑	1'-11 1/2" (W) x 1' (H)	IN. F. BRICK
2	↑	1'-11 1/2" (W) x 1' (H)	IN. F. BRICK
3	↑	BY THE 1" WIDE ONE LINTEL STOP ONLY 1/2" OF AN INCH EXT. UP SIDE OF THE STOP & 1/4" OF 1/2" OF AN IN.	IN. F. BRICK FOR ONE END, IN. F. BRICK FOR OTHER END, ONE END ONE IN. F. BRICK WITH NO OTHER END
4	↑	BY THE 1" WIDE ONE LINTEL STOP ONLY 1/2" OF AN INCH EXT. UP SIDE OF THE STOP & 1/4" OF 1/2" OF AN IN.	IN. F. BRICK FOR ONE END, IN. F. BRICK FOR OTHER END, ONE END ONE IN. F. BRICK WITH NO OTHER END
5	↑	1'-11 1/2" (W) x 1' (H)	IN. F. BRICK
6	↑	1'-11 1/2" (W) x 1' (H)	IN. F. BRICK
7	↑	1'-11 1/2" (W) x 1' (H)	IN. F. BRICK

J. P. THOMSON ASSOCIATES LTD.
ARCHITECTS & ENGINEER
WINDSOR CHATHAM

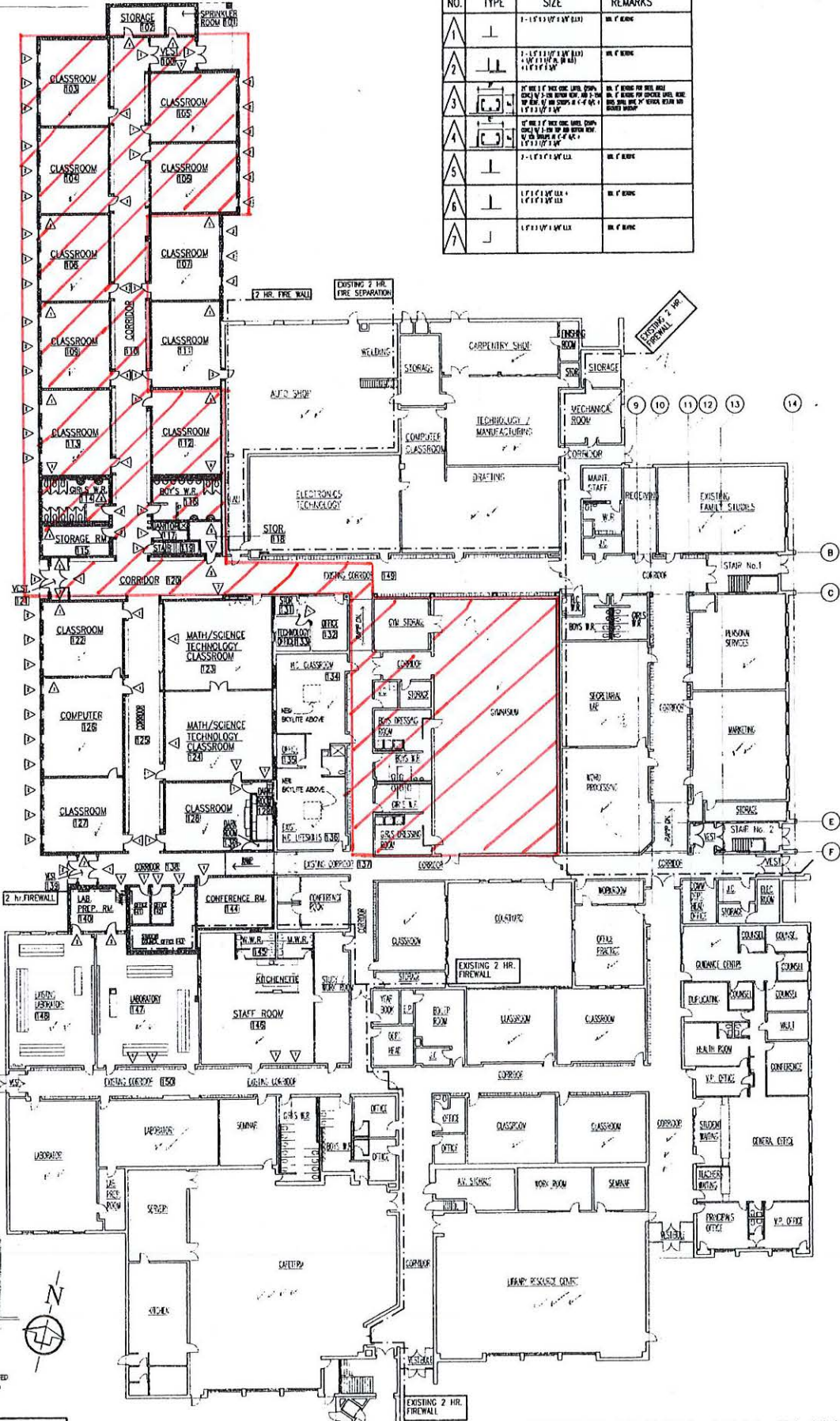

FIRST FLOOR KEY PLAN
SCALE: 1" = 20'-0"

All drawings and related documents are the copyright property of the ARCHITECT and must be returned upon request. Reproduction of drawings and related documents in part or whole is forbidden without the ARCHITECT'S WRITTEN PERMISSION.

A. DETAIL NO.
B. LOCATION SHEET
C. DETAILED ON

DATE ISSUED FOR
SEPT. 15, 1997 OWNERS APPROVAL
DEC. 8, 1997 BIDS & CONSTRUCTION

PROJECT
ADDITION & ALTERATIONS TO ST. ANNE SECONDARY SCHOOL
NORTH CAMPUS
TECUWSEH ONTARIO
FOR THE ESSEX COUNTY ROMAN CATHOLIC SEPARATE SCHOOL BOARD

DRAWING TITLE
FIRST AND SECOND FLOOR KEY PLANS, DEMOLITION PLAN, LINTEL SCHEDULE AND DETAILS

DATE: NOV. 24, 1997
SCALE: AS NOTED
DRAWN BY: TEAM 1
CHECKED BY:

APPROVED FOR CONSTRUCTION
DRAWING NO.: **A-2**
JOB FILE NO.: **97-126**

DOORS, FRAMES, WINDOWS, HANGING AND ELECTRICAL FIXTURES SHALL BE REMOVED BY THE OWNER'S CONTRACTOR.